

Horseheads 2030:  
Future (2<sup>nd</sup>) Referendum  
October 14, 2021



*HUNT* ENGINEERS | ARCHITECTS | SURVEYORS

# Referendum Planning Activities



- Develop Building Plans - Complete
- Evaluate Outstanding Needs - Complete
- Scope Development - Complete
  - High School
  - Middle School
  - Intermediate School
  - Elementary Schools
- Develop Estimates / Budgets - Complete
- Develop The Financial Plan - Complete
- SEQR Action - 10/14/21
- Proposed Construction Schedule - in Development -2022-2026

# Project Scope



- Big Flats / Ridge Road Elementary Schools
  - Classroom addition
  - Gymnasium/Auditorium Stage addition/renovations
  - Cafeteria/Kitchen relocation and renovation
  - Library relocation and renovation
  - HVAC upgrades and replacements
- Gardner Road Elementary
  - Classroom addition
  - Gymnasium renovations
  - Cafeteria/Kitchen Renovations
  - Library renovations
  - HVAC upgrades and replacements

# Project Scope



- Intermediate / Middle School
  - Roof replacements
  - Gymnasium & Locker rooms renovations
  - HVAC upgrades and replacements
  - Bus Loop and Parking renovations
- High School
  - Gymnasium & Locker rooms renovations / addition
  - East Parking Lot and Bus Drop off renovations
  - Roof replacements
- Stadium
  - Locker room additions



# Project Cost



HORSEHEADS CENTRAL SCHOOL DISTRICT Estimated Project Cost		
<i>HUNT # 1923-048</i>		<i>October 14, 2021</i>
Capital Construction Project	Earliest SED approval	Total Project Cost
FACILITY NAME		
Big Flats Elementary (Pre-K-4)	3/1/2023	<b>\$19,603,542</b>
Gardner Road Elementary (Pre-K-4)	3/1/2023	<b>\$17,568,761</b>
Ridge Road Elementary (Pre-K-4)	3/1/2023	<b>\$24,958,373</b>
Intermediate (5-6) / Middle School (7-8)	3/1/2022 & 3/1/2023	<b>\$12,354,839</b>
High School (9-12)	3/1/2024	<b>\$44,261,751</b>
Stadium Locker Rooms & Music Storage	3/1/2023	<b>\$3,507,727</b>
Bus Garage		<b>\$0</b>
Maintenance Building		<b>\$0</b>
HS Field House		<b>\$0</b>
<b>TOTALS</b>		<b>\$122,254,993</b>

# Expedited Schedule



Project Development		Wed 5/19/21	Wed 7/21/21
<b>BOE workshop - review of scope options</b>	<b>1 Day</b>	<b>Thurs 7/22/21</b>	
Develop Project Scope / Budgets	2 Weeks	Fri 7/23/21	Fri 8/6/21
<b>Present BOE Update Potential Scope/Budget</b>	<b>1 Day</b>	<b>Mon 8/9/21</b>	
Develop Project Scope / Budgets	1 Week	Tues 8/10/21	Tues 8/17/21
<b>Present BOE Potential Project Scope/Budget</b>	<b>1 Days</b>	<b>Tues 8/17/21</b>	
Develop Project Scope / Financials	2 Weeks	Wed 8/18/21	Tues 8/31/21
<b>Present BOE Project Scope / Financials</b>	<b>1 Days</b>	<b>Wed 9/1/21</b>	
Finalize Project Scope / Financials	1 Week	Thurs 9/2/21	Wed 9/8/21
<b>Present BOE Project Scope / Financials</b>	<b>1 Days</b>	<b>Thurs 9/9/21</b>	
SEQR Lead Agency Notification (Min 30 Days)	31 Days	Mon 9/13/21	Wed 10/13/21
<b>BOE SEQR Determination/ Referendum Resolution</b>	<b>1 Day</b>	<b>Thurs 10/14/21</b>	
Public Notice for Referendum (Min 45 Days from Legal Advertisement)	53 Days	Fri 10/15/21	Mon 12/6/21
<b>Legal Advertisement (1<sup>st</sup> Ad Min 45 Days Before Vote – total 4 times)</b>	<b>4 Times</b>	<b>Sat 10/23/21</b>	<b>Mon 12/6/21</b>
<b>Referendum Vote</b>	<b>1 Day</b>	<b>Tues 12/7/21</b>	



# BIG FLATS ELEMENTARY

EXISTING FLOOR PLAN

# HORSEHEADS CENTRAL SCHOOL DISTRICT

**HUNT** ENGINEERS | ARCHITECTS | SURVEYORS

HORSEHEADS, NY 607 - 358 - 1000 ROCHESTER, NY 585 - 327 - 7950 TOWANDA, PA 570 - 265 - 4868

COPYRIGHT: 2021



CLASSROOMS ADDED PER PROGRAM NEEDS: 6  
 CLASSROOMS ADDED PER CLASSROOM RIGHT-SIZING: 10  
 TOTAL: 16

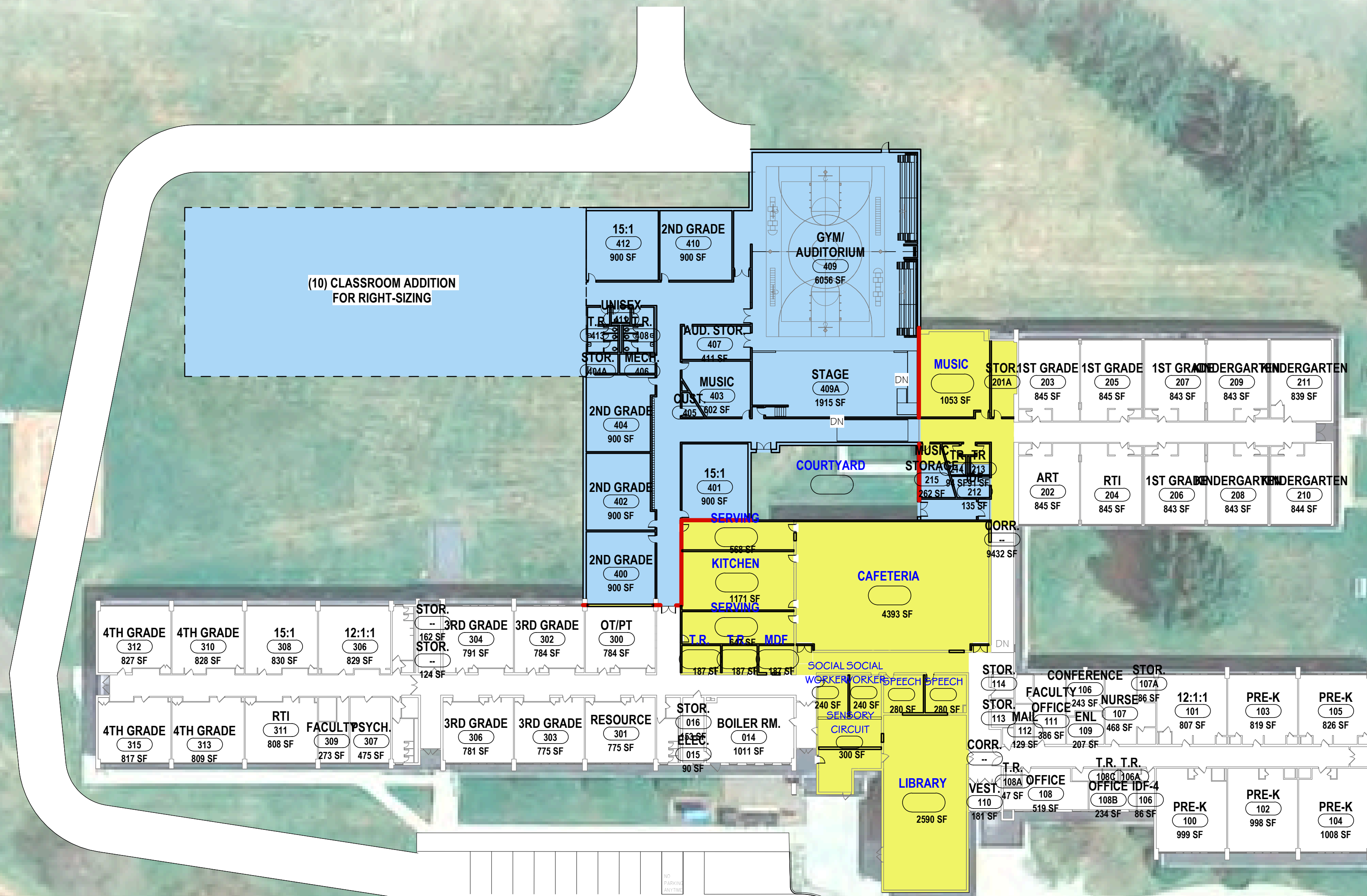

**PHASING KEY**

ADDITION	<span style="display: inline-block; width: 20px; height: 10px; background-color: #ADD8E6; border: 1px solid black;"></span>	20,692 SF
RENOVATIONS (PHASE 1)	<span style="display: inline-block; width: 20px; height: 10px; background-color: #FFFF00; border: 1px solid black;"></span>	15,634 SF



**BIG FLATS ELEMENTARY**  
**HORSEHEADS CENTRAL SCHOOL DISTRICT**

*PROPOSED LAYOUT*

**HUNT** ENGINEERS | ARCHITECTS | SURVEYORS  
 HORSEHEADS, NY 607 - 358 - 1000 ROCHESTER, NY 585 - 327 - 7950 TOWANDA, PA 570 - 265 - 4868

COPYRIGHT: 2021





1 FIRST FLOOR PLAN - EXISTING  
1/16" = 1'-0"



**GARDNER ROAD ELEMENTARY** *EXISTING PLAN*  
**HORSEHEADS CENTRAL SCHOOL DISTRICT**



CLASSROOMS ADDED PER PROGRAM NEEDS: 11  
 CLASSROOMS ADDED PER CLASSROOM RIGHT-SIZING: 0  
 TOTAL: 11



**PHASING KEY**

ADDITION ■ 13,755 SF  
 RENOVATIONS (PHASE 1) ■ 19,465 SF



**GARDNER ROAD ELEMENTARY** *PROPOSED LAYOUT*  
**HORSEHEADS CENTRAL SCHOOL DISTRICT**





**RIDGE ROAD ELEMENTARY** *EXISTING FLOOR PLAN*  
**HORSEHEADS CENTRAL SCHOOL DISTRICT**



CLASSROOMS ADDED PER PROGRAM NEEDS: 14  
 CLASSROOMS ADDED PER CLASSROOM RIGHT-SIZING: 0  
 TOTAL: 14



**PHASING KEY**

ADDITION ■ 23,303 SF  
 RENOVATIONS (PHASE 1) ■ 21,714 SF



**RIDGE ROAD ELEMENTARY**  
**HORSEHEADS CENTRAL SCHOOL DISTRICT**

PROPOSED LAYOUT



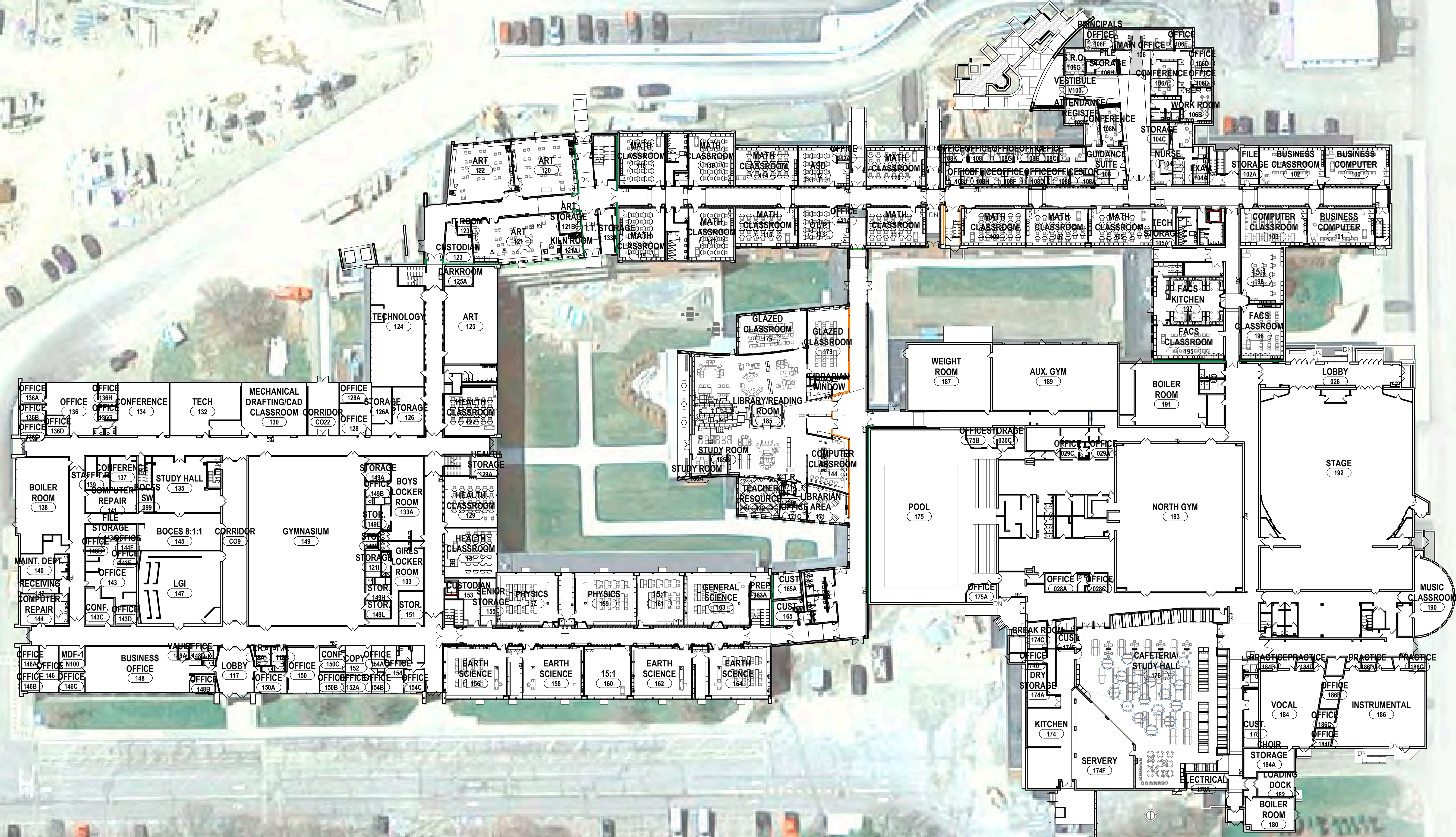

**HORSEHEADS HIGH SCHOOL** *FIRST FLOOR - EXISTING*  
**HORSEHEADS CENTRAL SCHOOL DISTRICT**

**HUNT** ENGINEERS | ARCHITECTS | SURVEYORS

HORSEHEADS, NY 607 - 358 - 1000 ROCHESTER, NY 585 - 327 - 7950 TOWANDA, PA 570 - 265 - 4868



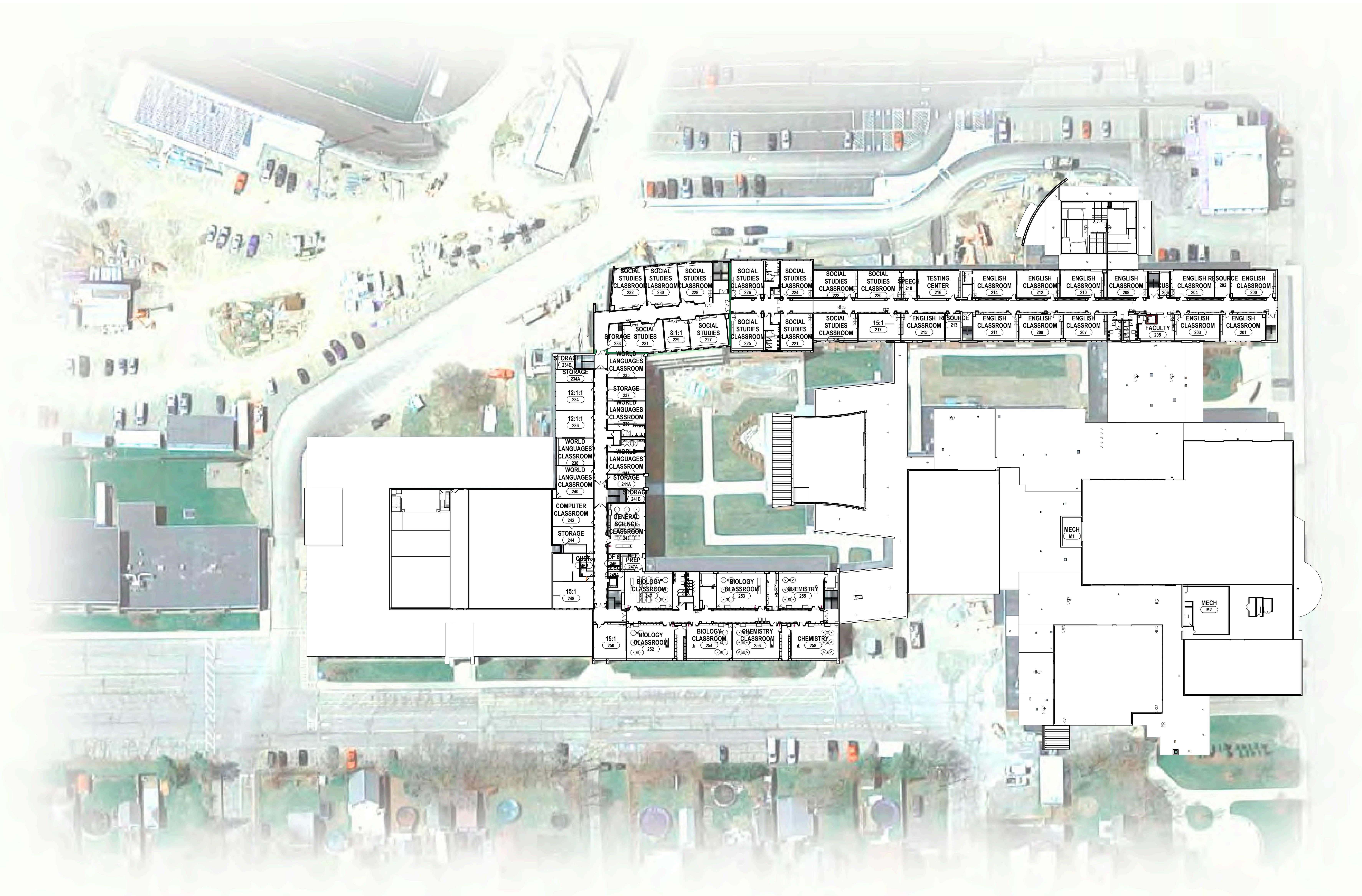

**HORSEHEADS HIGH SCHOOL**      *SECOND FLOOR - EXISTING*  
**HORSEHEADS CENTRAL SCHOOL DISTRICT**

**HUNT** ENGINEERS | ARCHITECTS | SURVEYORS  
 HORSEHEADS, NY 607 - 358 - 1000    ROCHESTER, NY 585 - 327 - 7950    TOWANDA, PA 570 - 265 - 4868



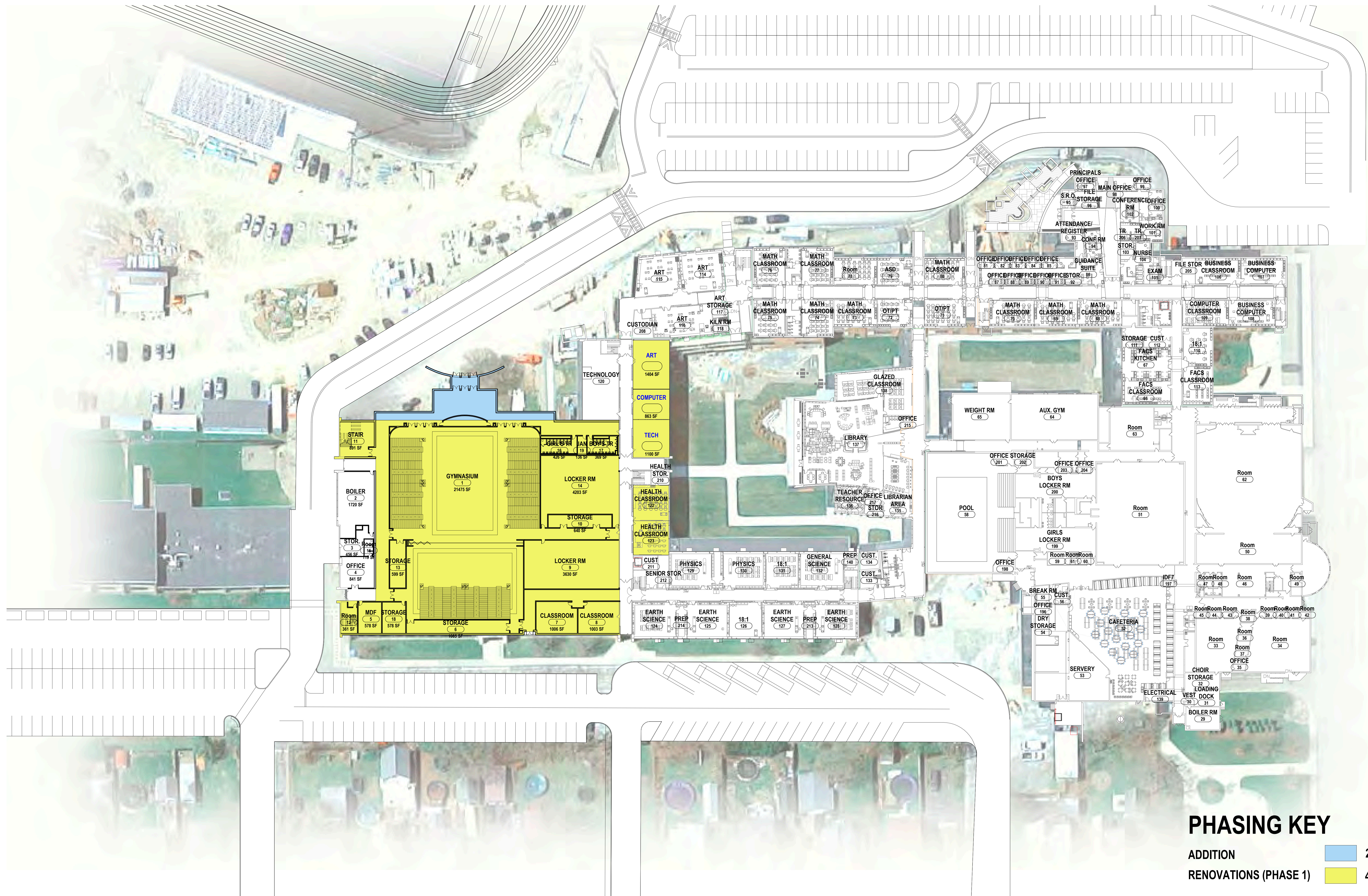

### PHASING KEY

- ADDITION  2,788 SF
- RENOVATIONS (PHASE 1)  48,782 SF

NUMBER OF CLASSROOMS LOST : 2  
 NUMBER OF CLASSROOMS ADDED : 2



# HORSEHEADS HIGH SCHOOL

PROPOSED LAYOUT - FIRST LAYOUT

# HORSEHEADS CENTRAL SCHOOL DISTRICT

**HUNT** ENGINEERS | ARCHITECTS | SURVEYORS



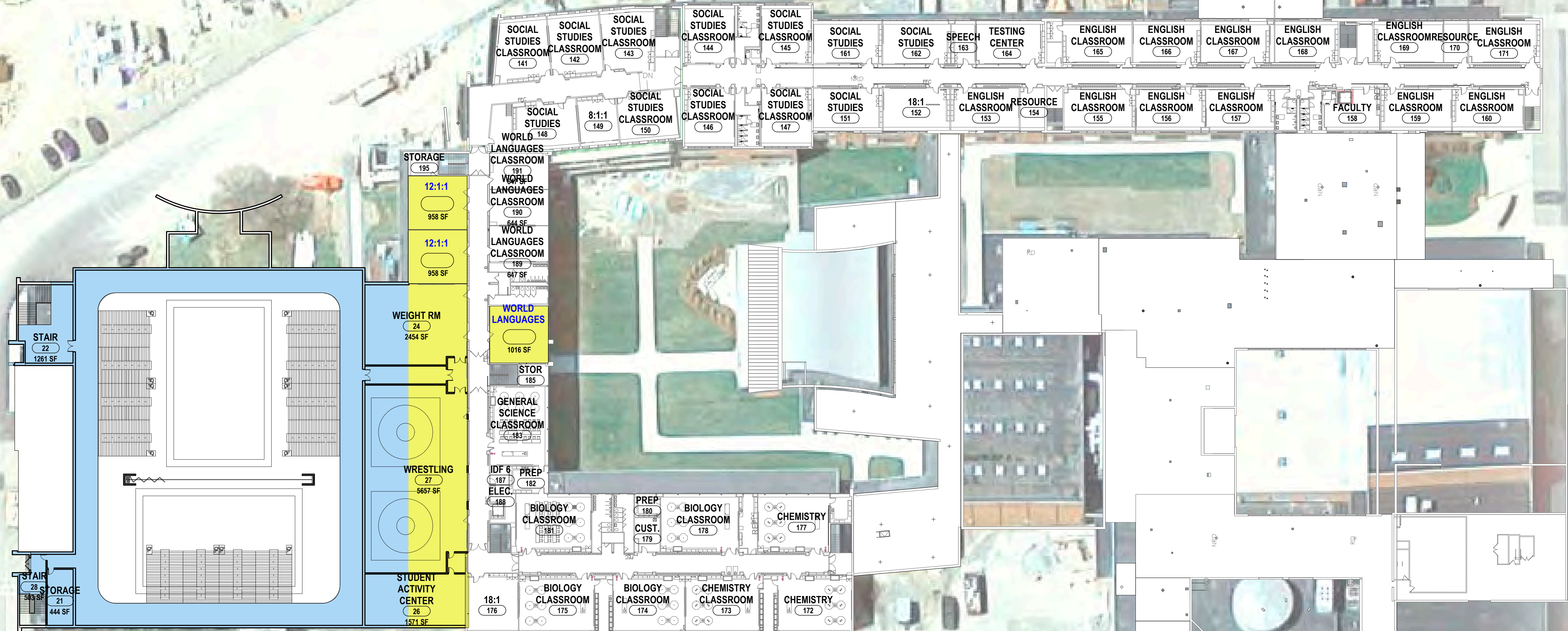

**PHASING KEY**

ADDITION	<span style="display: inline-block; width: 20px; height: 10px; background-color: #ADD8E6; border: 1px solid black;"></span>	16,547 SF
RENOVATIONS (PHASE 1)	<span style="display: inline-block; width: 20px; height: 10px; background-color: #FFFF00; border: 1px solid black;"></span>	9,080 SF

NUMBER OF CLASSROOMS LOST : 4



**HORSEHEADS HIGH SCHOOL**

*PROPOSED LAYOUT - SECOND FLOOR*

**HORSEHEADS CENTRAL SCHOOL DISTRICT**

**HUNT** ENGINEERS | ARCHITECTS | SURVEYORS

HORSEHEADS, NY 607 - 358 - 1000 ROCHESTER, NY 585 - 327 - 7950 TOWANDA, PA 570 - 265 - 4868

COPYRIGHT: 2021



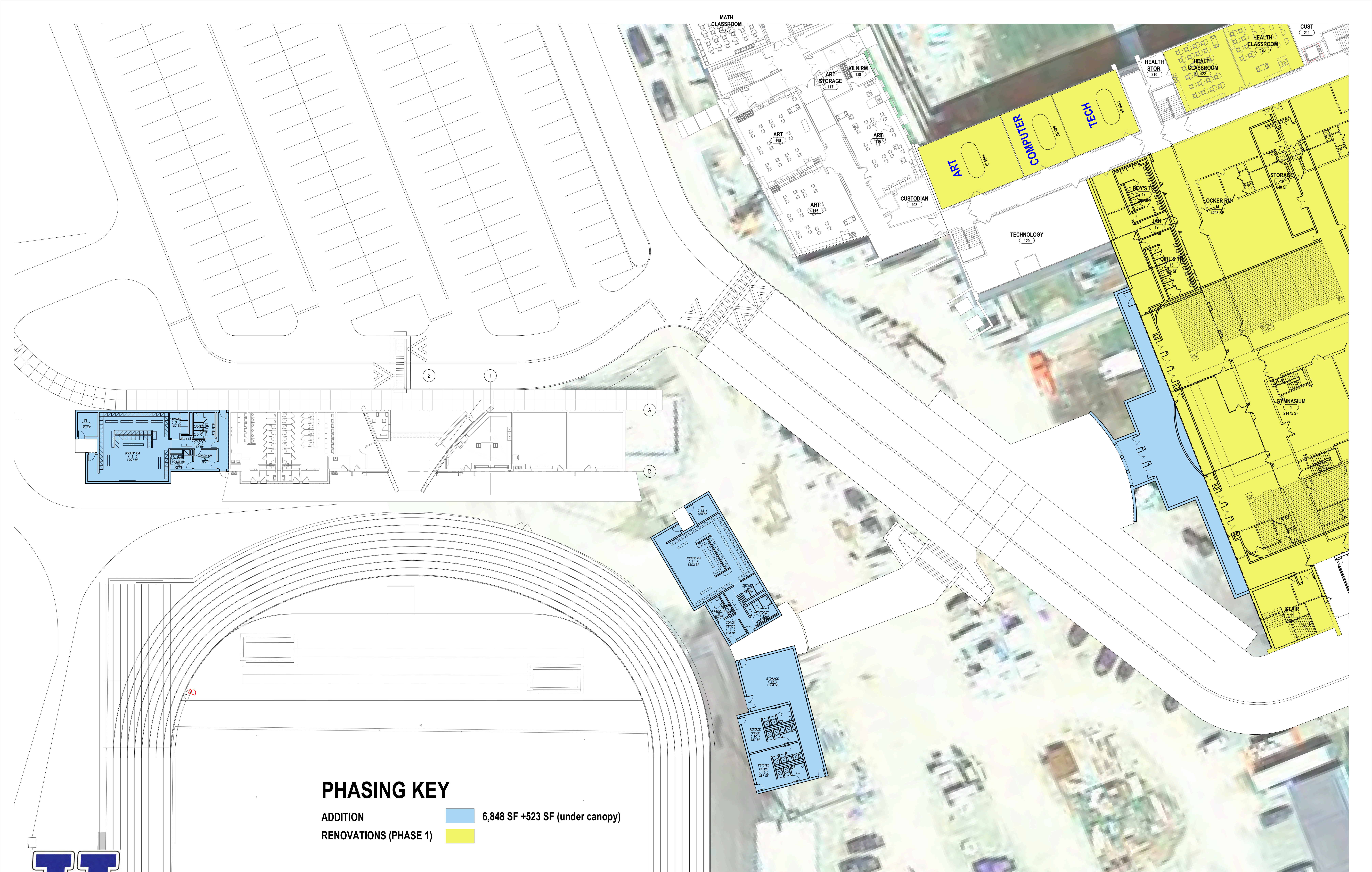

**PHASING KEY**

ADDITION  6,848 SF +523 SF (under canopy)

RENOVATIONS (PHASE 1)

**HORSEHEADS HIGH SCHOOL** STADIUM LOCKER ROOMS - PROPOSED LAYOUT

**HORSEHEADS CENTRAL SCHOOL DISTRICT**







# HORSEHEADS MIDDLE SCHOOL

EXISTING

# HORSEHEADS CENTRAL SCHOOL DISTRICT

**HUNT** ENGINEERS | ARCHITECTS | SURVEYORS

HORSEHEADS, NY 607 - 358 - 1000 ROCHESTER, NY 585 - 327 - 7950 TOWANDA, PA 570 - 265 - 4868

COPYRIGHT: 2021





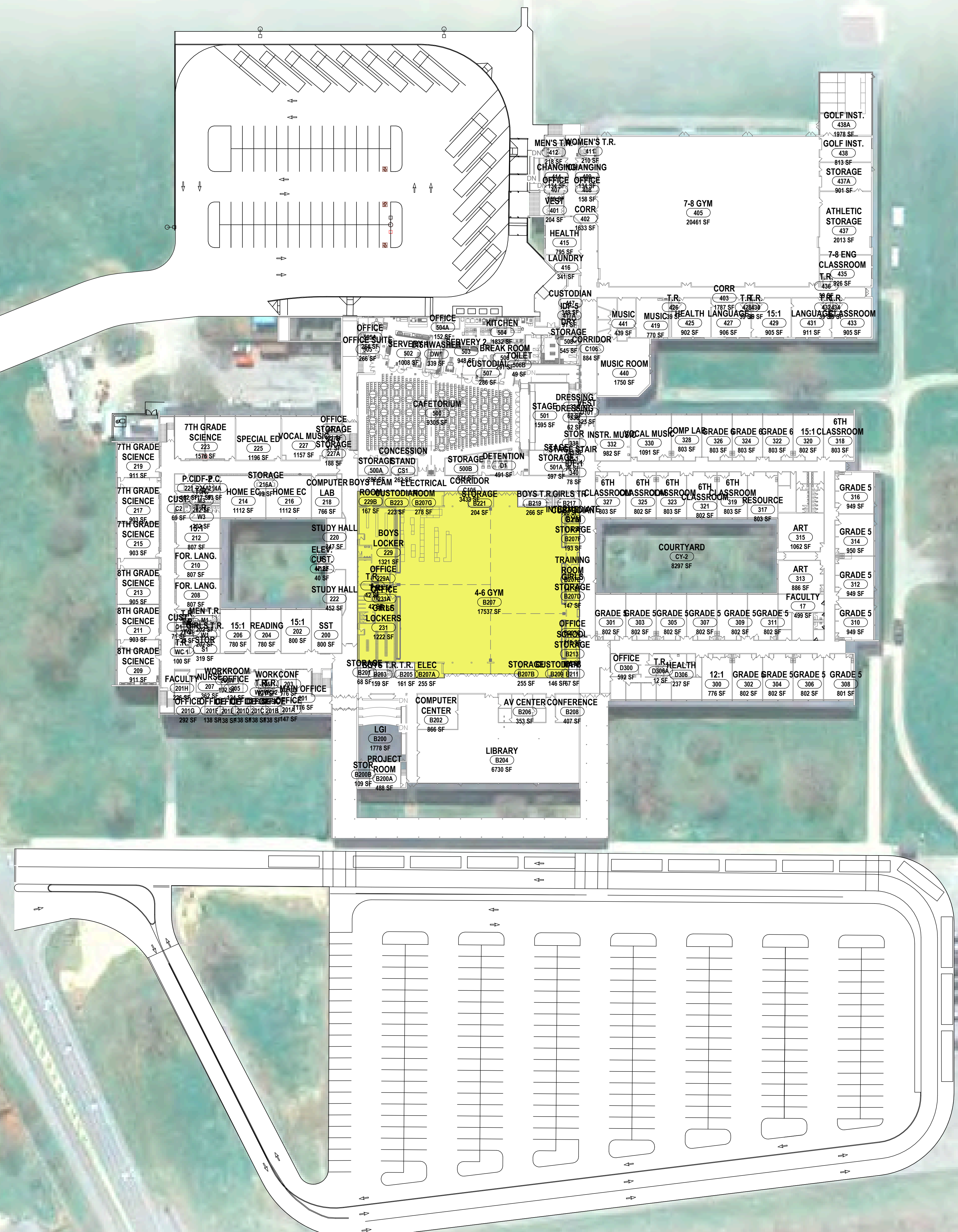

**PHASING KEY**

RENOVATIONS (PHASE 1)  24,381 SF



**HORSEHEADS MIDDLE SCHOOL**

*PROPOSED LAYOUT - FIRST FLOOR*

**HORSEHEADS CENTRAL SCHOOL DISTRICT**

**HUNT** ENGINEERS | ARCHITECTS | SURVEYORS

HORSEHEADS, NY 607 - 358 - 1000 ROCHESTER, NY 585 - 327 - 7950 TOWANDA, PA 570 - 265 - 4868

COPYRIGHT: 2021